



Websters
estate agents

Ground Floor 41 Gould Road, Twickenham, TW2 6RN

Desirable and deceptively spacious 2 bed period conversion flat in a popular location just off Twickenham Green.

The property is on the ground floor, has a share of the freehold and a stunning 30ft south facing garden.

The living room has space for both lounge and dining room furniture and also has a designated study area.

Light oak flooring runs throughout and there are 2 double bedrooms, a luxury bathroom and a modern fitted kitchen. A stable door opens from the kitchen onto the garden which has a patio, lawn, storage shed and rear access.

- Private 30ft South Facing Garden
- 2 Double Bedrooms
- Ground Floor Period Conversion Flat
- Luxury Bathroom & Kitchen
- Gas Central Heating
- Tastefully Presented
- Twickenham Green 350 Yards
- Twickenham Mainline Station less than an Mile



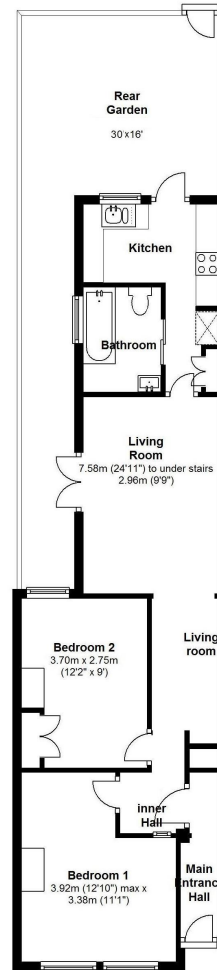

Ground Floor

Total Floor Area approx. 591 Sq.Feet (54.90 sq.metres)

a Websters Estate Agents 36 Broad Street, Teddington, Middlesex TW11 8QY

t 020 8614 6000

e sales@mywebsters.co.uk **w** mywebsters.co.uk

Disclaimer

These particulars, whilst believed to be accurate are set out as a general outline only for guidance and do not constitute any part of an offer or contract. Intending purchasers should not rely on them as statements of representation of fact, but must satisfy themselves by inspection or otherwise as to their accuracy. We have not carried out a detailed survey nor tested the services, appliances and specific fittings. Room sizes should not be relied upon for carpets and furnishings. The measurements given are approximate. No person in this firm's employment has the authority to make or give any representation or warranty in respect of the property.

