



Websters
estate agents

Staines Road, Twickenham, TW2 5AW

A charming first floor 1 bedroom conversion flat in an imposing period building believed to be built in 1856.

Tastefully presented with high ceilings and a light and airy feel throughout, this is a welcoming and desirable property.

The living room has wood flooring and double doors opening onto an ornamental balcony, with southerly views over the front garden, whilst the bedroom with built-in wardrobes, overlooks the rear. Modern and stylish kitchen and shower room.

Residents have the benefit of off street parking to the rear on a first come basis.

The property has been designated a Building of Townscape Merit status and sits on the edge of Belmont Road conservation area.

Twickenham Green is less than 0.35 miles away.

- Period Conversion Property
- 1 Double Bedroom
- Modern Kitchen and Shower Room
- Separate Living Room
- Built in Storage
- High Ceilings
- Off Street Parking
- Twickenham Green 0.35 Miles

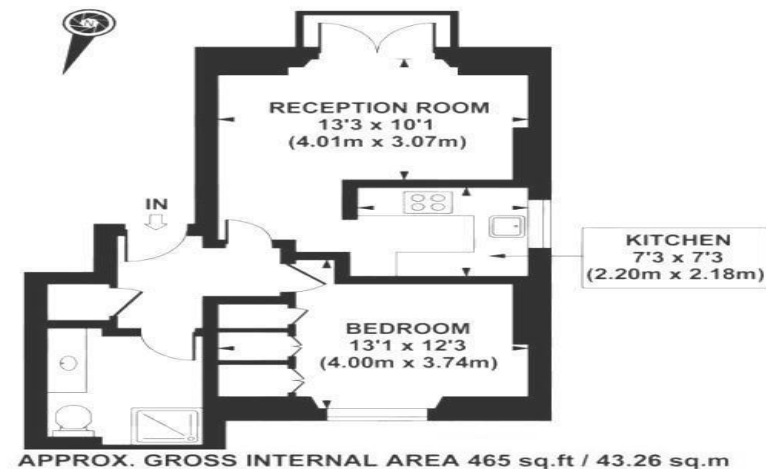

a Websters Estate Agents 36 Broad Street, Teddington, Middlesex TW11 8QY **t** 020 8614 6000 **e** sales@mywebsters.co.uk **w** mywebsters.co.uk

Disclaimer

These particulars, whilst believed to be accurate are set out as a general outline only for guidance and do not constitute any part of an offer or contract. Intending purchasers should not rely on them as statements of representation of fact, but must satisfy themselves by inspection or otherwise as to their accuracy. We have not carried out a detailed survey nor tested the services, appliances and specific fittings. Room sizes should not be relied upon for carpets and furnishings. The measurements given are approximate. No person in this firm's employment has the authority to make or give any representation or warranty in respect of the property.

