



Websters
estate agents

Lyndhurst Avenue, Twickenham, TW2 6BU

Deceptively spacious, 3 double bedroom detached bungalow situated in a popular tree lined avenue forming part of the sought after Woodllawn Estate.

This well kept property has a 40ft+ frontage, single garage and driveway parking for at least 4 vehicles. The roof space is very spacious and further accommodation could be created, subject to the usual planning/building requirements. Planning permission has been granted for a large conservatory.

All the rooms are of a decent size and the overall accommodation is circa 1175 sq ft. The kitchen/breakfast room opens directly onto the garden. The master bedroom has an en suite wet room, built in wardrobes and also has double doors opening onto the rear garden. There is also a study and useful entrance hallway/reception area.

A lovely feature is the patio and lawned rear garden 75ft x 40ft approximately.

- Detached Bungalow
- 75ft x 40ft Rear Garden
- 40ft+ Wide Plot
- 3 Double Bedrooms
- 2 Reception Rooms
- Family Bathroom & En Suite Wet Room
- Driveway & Garage



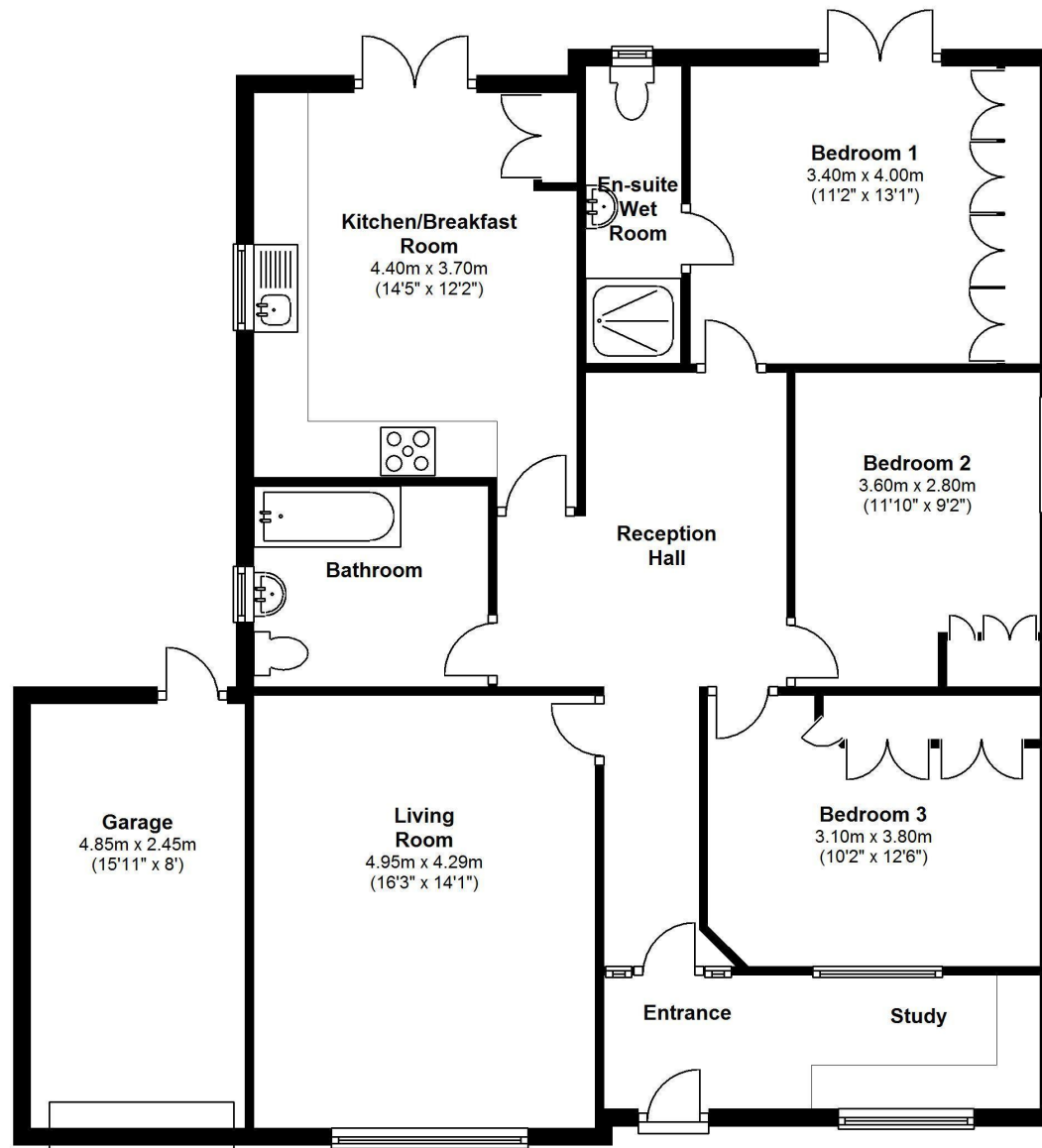

*Total Floor area approx. 1,175 Sq.Feet (109.13 sq.metres)
excludes Garage area.*

a Websters Estate Agents 36 Broad Street, Teddington, Middlesex TW11 8QY

t 020 8614 6000

e sales@mywebsters.co.uk w mywebsters.co.uk

Disclaimer

These particulars, whilst believed to be accurate are set out as a general outline only for guidance and do not constitute any part of an offer or contract. Intending purchasers should not rely on them as statements of representation of fact, but must satisfy themselves by inspection or otherwise as to their accuracy. We have not carried out a detailed survey nor tested the services, appliances and specific fittings. Room sizes should not be relied upon for carpets and furnishings. The measurements given are approximate. No person in this firm's employment has the authority to make or give any representation or warranty in respect of the property.

