



MILTON LODGE

Websters
estate agents

Whitton Road, Twickenham, TW1 1BU

First Floor 1 bedroom apartment in a popular well maintained development. Set within attractive communal grounds just 0.2 miles from Twickenham mainline station and the A316 with direct access to the M3/M25 and into central London.

With vacant possession and no onward chain, this stylish light and airy apartment offers 431 sq ft of living space with a quiet southerly facing aspect overlooking the well presented gardens. Immaculately presented throughout with an attractive communal lobby, secure entry phone system, high specification fixtures, fittings and flooring, original doors, double glazed windows and modern neutral decor.

Entrance hallway with storage cupboards leads to the luxury bathroom, the fitted kitchen and into the spacious living room with a large bay window and a door into the double bedroom.

Located 0.5 miles from Twickenham town centre, Church Street shops and restaurants and the River Thames with towpath walks to Marble Hill Park and into Richmond.

EPC Rating C

- First Floor 1 Bedroom Apartment
- Share of Freehold, Vacant Possession and No Chain
- Popular Well Maintained Development
- Immaculately Presented Throughout
- Set Within Landscaped Communal Grounds
- Spacious Living Room and Separate Kitchen
- 0.2 Miles from Twickenham Mainline Station



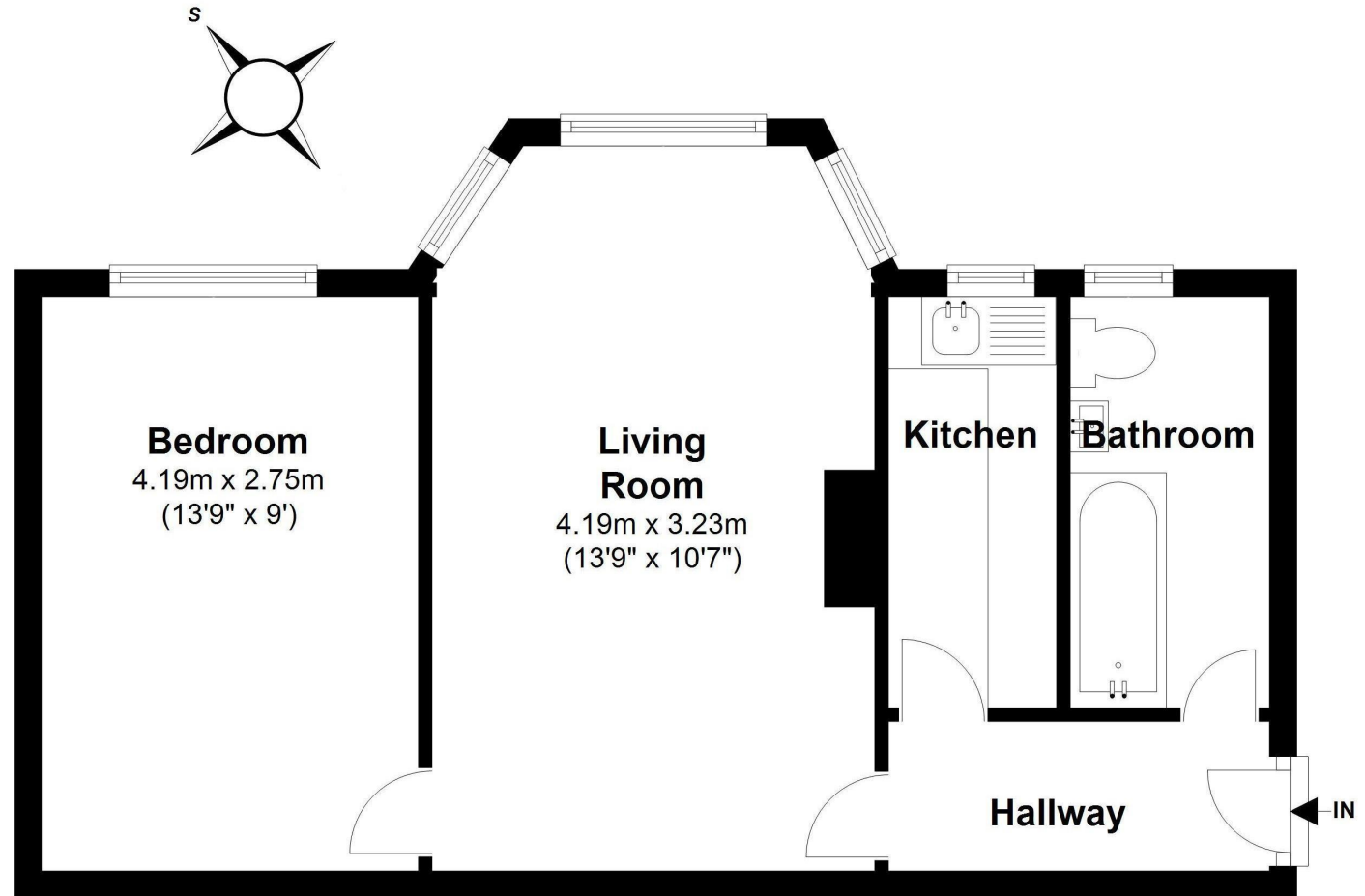

Total Floor Area approx.=431 Sq.Feet (40 sq.metres)

Milton Lodge, Twickenham

a Websters Estate Agents 164 Heath Road, Twickenham, Middlesex TW1 4BN t 020 8892 3343 e sales@mywebsters.co.uk w mywebsters.co.uk

Disclaimer

These particulars, whilst believed to be accurate are set out as a general outline only for guidance and do not constitute any part of an offer or contract. Intending purchasers should not rely on them as statements of representation of fact, but must satisfy themselves by inspection or otherwise as to their accuracy. We have not carried out a detailed survey nor tested the services, appliances and specific fittings. Room sizes should not be relied upon for carpets and furnishings. The measurements given are approximate. No person in this firm's employment has the authority to make or give any representation or warranty in respect of the property.

