



Websters
estate agents
01203 8892 3343
www.websters.co.uk For Sale

Websters
estate agents

Hamilton Road, Twickenham, TW2 6SN

Mid Terrace 2 double bedroom Victorian cottage with an attractive landscaped garden. Situated in a quiet cul-de-sac location only 0.2 miles from Twickenham Green, local shops, bars and restaurants, 0.4 miles from Archdeacon Primary and 0.6 miles from Trafalgar Primary School.

With vacant possession and no onward chain.

Extended at the rear and tastefully refurbished throughout to offer 822 sq ft of well proportioned living space with high specification fixtures, fittings and flooring, double glazed sash windows with plantation shutters and pleasing neutral decor

Front door opens into the hallway with a door to the living room and a door to the kitchen/family room at the rear. This spacious room has a stylish fitted kitchen with granite worktops, space for dining/seating, a w.c and doors opening directly onto the lovely garden. On the first floor are 2 double bedrooms, the luxury family bathroom and access to loft storage.

Located only 0.6 miles from Church Street, the River Thames and towpath walks past Marble Hill Park into Richmond and just 0.7 miles from Strawberry Hill and Twickenham mainline train stations.

EPC Rating D

- Mid Terrace Victorian Cottage
- 2 Double Bedrooms and Upstairs Bathroom
- Vacant Possession and No Chain
- Living Room and Separate Kitchen/Family Room
- High Specification Throughout
- Attractive Rear Garden
- 0.2 Miles from Twickenham Green



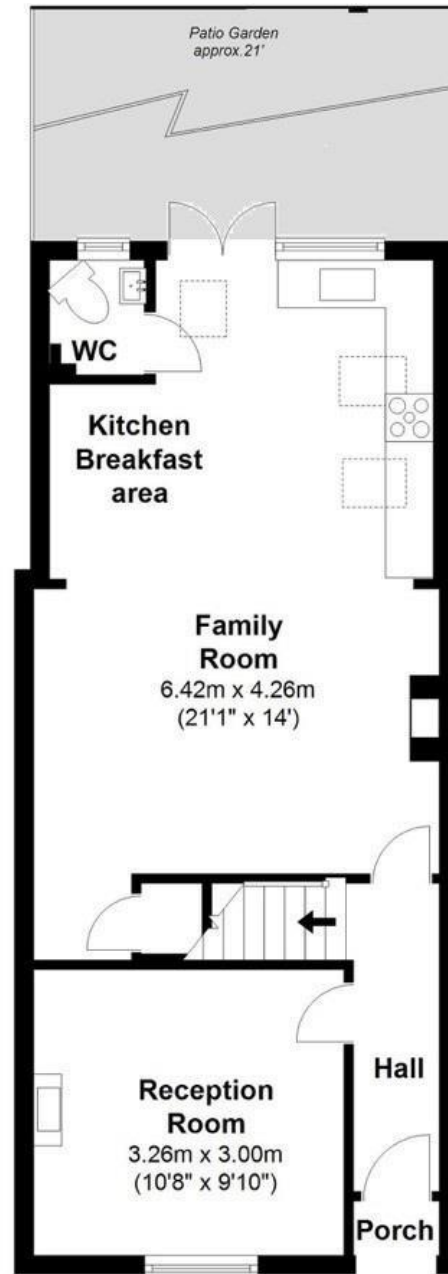

Ground Floor

Total Floor Area approx. = 822 Sq. Feet (76.33sq.metres)

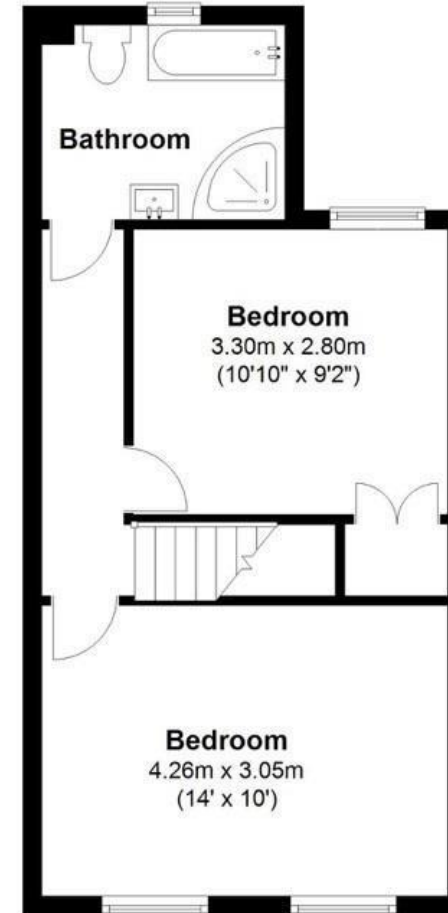

First Floor

Hamilton Road, Twickenham

a Websters Estate Agents 164 Heath Road, Twickenham, Middlesex TW1 4BN

t 020 8892 3343

e sales@mywebsters.co.uk w mywebsters.co.uk

Disclaimer

These particulars, whilst believed to be accurate are set out as a general outline only for guidance and do not constitute any part of an offer or contract. Intending purchasers should not rely on them as statements of representation of fact, but must satisfy themselves by inspection or otherwise as to their accuracy. We have not carried out a detailed survey nor tested the services, appliances and specific fittings. Room sizes should not be relied upon for carpets and furnishings. The measurements given are approximate. No person in this firm's employment has the authority to make or give any representation or warranty in respect of the property.

