



Websters
estate agents

Amyand Cottages, St Margarets, TW1 3JA

Mid Terrace 3 double bedroom family home with a south facing garden in a cul-de-sac location. Situated just 0.2 miles from St Margarets Village and mainline train station and less than 0.3 miles from St Stephen's, St Mary's and Orleans Primary Schools and Orleans Park Secondary/Sixth Form.

Extended, loft converted and refurbished by the current owners to an impressive standard to offer 1033 sq ft of well proportioned living space over 3 floors. Immaculately presented with high specification fixtures, fittings and floorings, double glazed windows, energy efficient boiler, heating system and appliances and pleasing neutral decor throughout.

Entrance hallway leads to the bay fronted living room, a w.c and into the open plan kitchen/family room at the rear. This fabulous light filled room has a stylish fitted kitchen with a range cooker and integrated appliances, space for dining and seating and a feature brick wall. Full width folding doors open onto the south facing low maintenance garden with attractive planting and secure gated rear access. On the first floor are 2 double bedrooms and the family bathroom with stairs up to the third bedroom with garden views and eaves storage.

Located 0.4 miles from the A316 with direct access to the M3/M25 and into central London and 0.5 miles from Twickenham town centre and train station.
EPC Rating C

- Mid Terrace 3 Double Bedroom Home
- St Margarets Cul-de-Sac Location
- Extended, Loft Converted and Refurbished
- South Facing Rear Garden
- Immaculately Presented Throughout
- Living Room and Kitchen/Family Room
- 0.2 Miles from St Margarets Village and Station



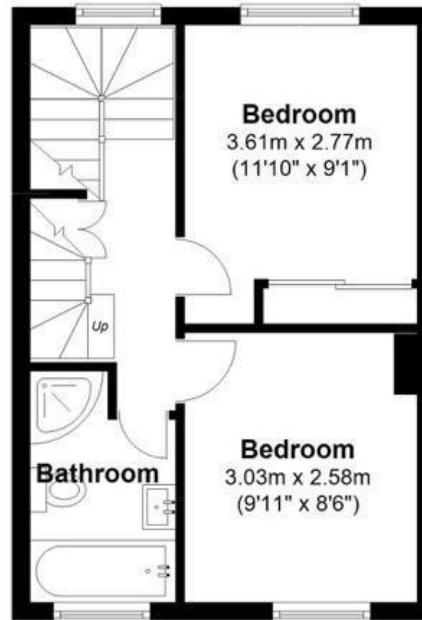
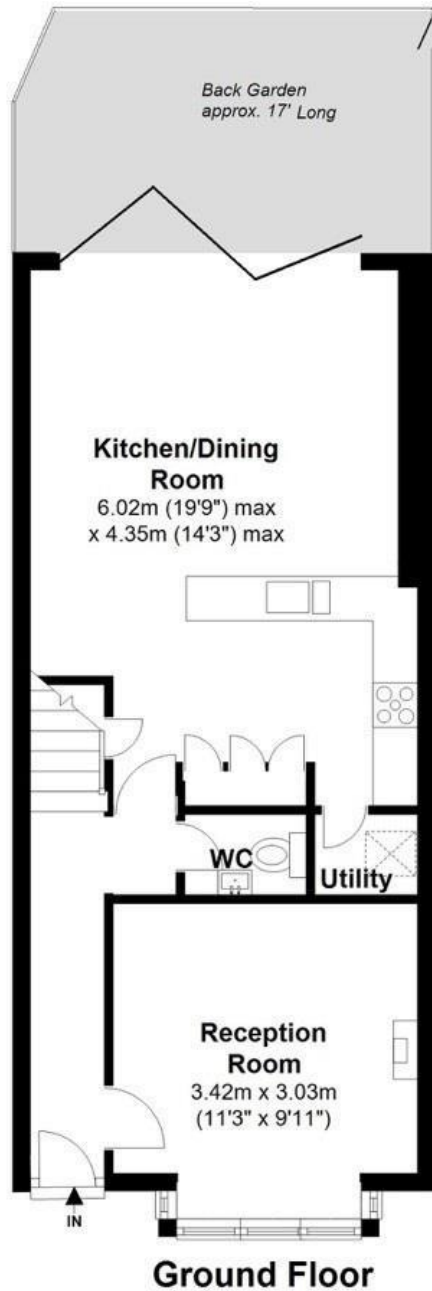

First Floor



Second Floor

Total Floor Area approx. = 1,033 Sq.feet (96 sq.metres)

a Websters Estate Agents 164 Heath Road, Twickenham, Middlesex TW1 4BN t 020 8892 3343 e sales@mywebsters.co.uk w mywebsters.co.uk

Disclaimer
These particulars, whilst believed to be accurate are set out as a general outline only for guidance and do not constitute any part of an offer or contract. Intending purchasers should not rely on them as statements of representation of fact, but must satisfy themselves by inspection or otherwise as to their accuracy. We have not carried out a detailed survey nor tested the services, appliances and specific fittings. Room sizes should not be relied upon for carpets and furnishings. The measurements given are approximate. No person in this firm's employment has the authority to make or give any representation or warranty in respect of the property.

